



Northeast

500kW Rental Package



Features

Cummins® Power Generation Sets

- Cummins engines, Newage Alternators and Power Command Controls - Designed, built, certified prototype tested and warranted by the only company that controls the process from start to finish.
- Supported exclusively worldwide by your Cummins Distributors.
- Utilize proven standard generator set designs.
- Includes jacket water heaters for more reliable operation in emergency standby applications

Cummins Diesel Engines

- Lightweight, compact and excellent fuel economy .
- Operate at up to 45°C (113°F) with no effect on output.
- Equipped with Heavy Duty Air Cleaners and Bypass-type Oil Filters

Newage® Alternators

- Designed and built by Cummins Power Generation.
- Flexible, reconnectable (208/480 VAC model) and parallel capable.
- Oversized alternators for improved motor starting and low temperature rise in prime and continuous applications.
- Permanent Magnet excitation for improved performance in cyclic and non-linear load applications.

PowerCommand® Paralleling Controls

- The most advanced, reliable and capable generator set control system available in the market today.
- Integrated generator set governing, voltage regulation, protection and paralleling functionality in one easy-to-operate customer interface.
- Multiple units and grid paralleling ready.
- Remote monitoring and operation ready
- Integrated Ground Fault Indication
- Optional freestanding, electronically operated closed-transition transfer switches are available.

Cummins Cooling System

- Optimized for maximum efficiency and minimum noise.
- Filled with propylene glycol coolant for greater environmental protection.

Custom Switchgear

- Designed and built to meet severe customer requirements.
- Automatic start/stop control for applications using Automatic Transfer Switches.
- Easy to Connect to your existing installation.
- 5-cycle closure, motor operated circuit breaker for automatic paralleling.
- Convenient Shore Power connection provides power to interior lighting, jacket water heaters, battery charger and alternator anti-condensation space heaters allowing quick starts even in arduous applications.

Customized ISO Container Enclosure

- Easy-to-transport.
- Optimal unit protection with minimum size.
- Optimized fuel capacity.
- Fluid containment design for greater environmental protection.
- Sound attenuated to minimize impact on local environment.
- Vertical cooling air and engine exhaust path to minimize sound level adjacent to the container.
- Equipped with 120VAC and 24VDC lighting.

Running Gear

- 20 foot sliding boggie chassis.
- Five-foot extension work area for convenience.
- Anti-Lock Brake System.

Ratings Definitions

Standby:	Prime (Unlimited Running Time):	Base Load (Continuous):
Applicable for supplying emergency power for the duration of normal power interruption. No sustained overload capability is available for this rating. Nominally rated. (Equivalent to Fuel Stop Power in accordance with ISO3046, AS2789, DIN6271, and BS5514.)	Applicable for supplying power in lieu of commercially purchased power. Prime power is the maximum power available at a variable load for an unlimited number of hours. A 10% overload capability is available for limited time. Nominally rated. (Equivalent to Prime Power in accordance with ISO8528 and Overload Power in accordance with ISO3046, AS2789, DIN6271, and BS5514.)	Applicable for supplying power continuously to a load for this rating. Nominally rated. Consult authorized distributor for rating. (Equivalent to Continuous Power in accordance with ISO8528, ISO3046, AS2789, DIN6271, and BS5514.)



Optional Features Shown

PowerCommand® Control with AmpSentry™ Protection

- Integrated automatic voltage regulator and engine speed governor
- AmpSentry Protection guards the electrical integrity of the alternator and power system from the effects of overcurrent, over/under voltage, under frequency and overload conditions
- Control components designed to withstand the vibration levels typical in generator sets

Standard Control Description

- | | |
|---|--|
| <ul style="list-style-type: none"> • Analog % of current meter (amps) • Analog AC frequency meter • Analog AC voltage meter • Analog % of load meter (kW) • Cycle cranking control • Digital display panel • Emergency stop switch • Idle mode control • Menu switch | <ul style="list-style-type: none"> • Panel backlighting • Remote starting, 12 volt, 2 wire • Reset switch • Run-Off-Auto switch • Sealed front panel, gasketed door • Self diagnostics • Separate customer interconnection box • Voltmeter/Ammeter phase selector switch |
|---|--|

Standard Protection Functions

Warnings

- High Coolant Temperature
- High DC Voltage
- Low Coolant Temperature
- Low DC Voltage
- Low Oil Pressure
- Over Current
- Oil Pressure Sender Fault
- Overload Load Shed Contacts
- Temperature Sender Fault
- Up to Four Customer Fault Inputs
- Weak Battery

Shutdowns

- Emergency Stop
- Fail to Crank
- High AC Voltage
- High Coolant Temperature
- Low Coolant Level (option for alarm only)
- Low AC Voltage
- Low Oil Pressure
- Magnetic Pickup Failure
- Overcrank
- Overcurrent
- Overspeed
- Short Circuit
- Underfrequency

Standard Performance Data

AC Alternator Data

- Current by Phase
- Kilowatts
- Kilowatt Hours
- Power Factor
- Voltage Line to Line
- Voltage Line to Neutral

Engine Data

- Battery Voltage
- Coolant Temperature
- Engine Running Hours
- Engine Starts Counter
- Oil Pressure
- Oil Temperature
- RPM

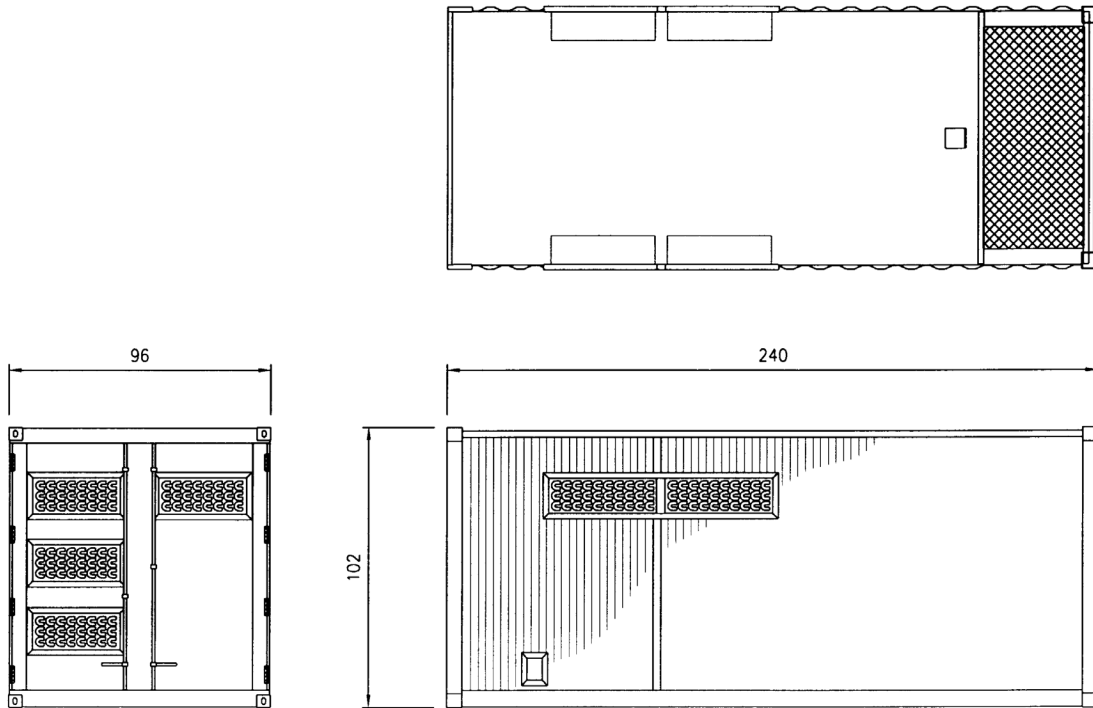

Model	Length		Width		Height		Weight (w/o Fuel)		Weight (with Fuel)		Fuel Capacity	
	in	mm	in	mm	in	mm	lbs	kg	lbs	kg	US Gal	liters
DFED	300	7620	96	2438	144	3658	37000	16783	40905	18553	550	2082

Model	kW Rating		Cummins Engine Model	Sound Level	Generator Specification Sheet #	Hours of Operation (75% Prime Load)	
	Standby	Prime				Standby	Prime
DFED	500	455	N14-G2	76	S-1059	21	23



Northeast

Cummins Power Generation
 1400 73rd Avenue N.E.
 Minneapolis, MN 55432
 612-574-5000
 1-877-POWR-NOW (877-769-7669)
 Fax: 612-574-8087

See your distributor for more information.

Backfeed to a utility system can cause electrocution and/or property damage. Do not connect to any building's electrical system except through an approved device or after building main switch is opened.

Cummins is a registered trademark of Cummins Engine Company. Power Rent is a service mark of Cummins Engine Company. PowerCommand is a trademark of Onan Corporation. AmpSentry is a trademark of Onan Corporations. Newage is a registered trademark of the Newage Company.